

HVSF ALTERNATE ENTRANCE STUDIES

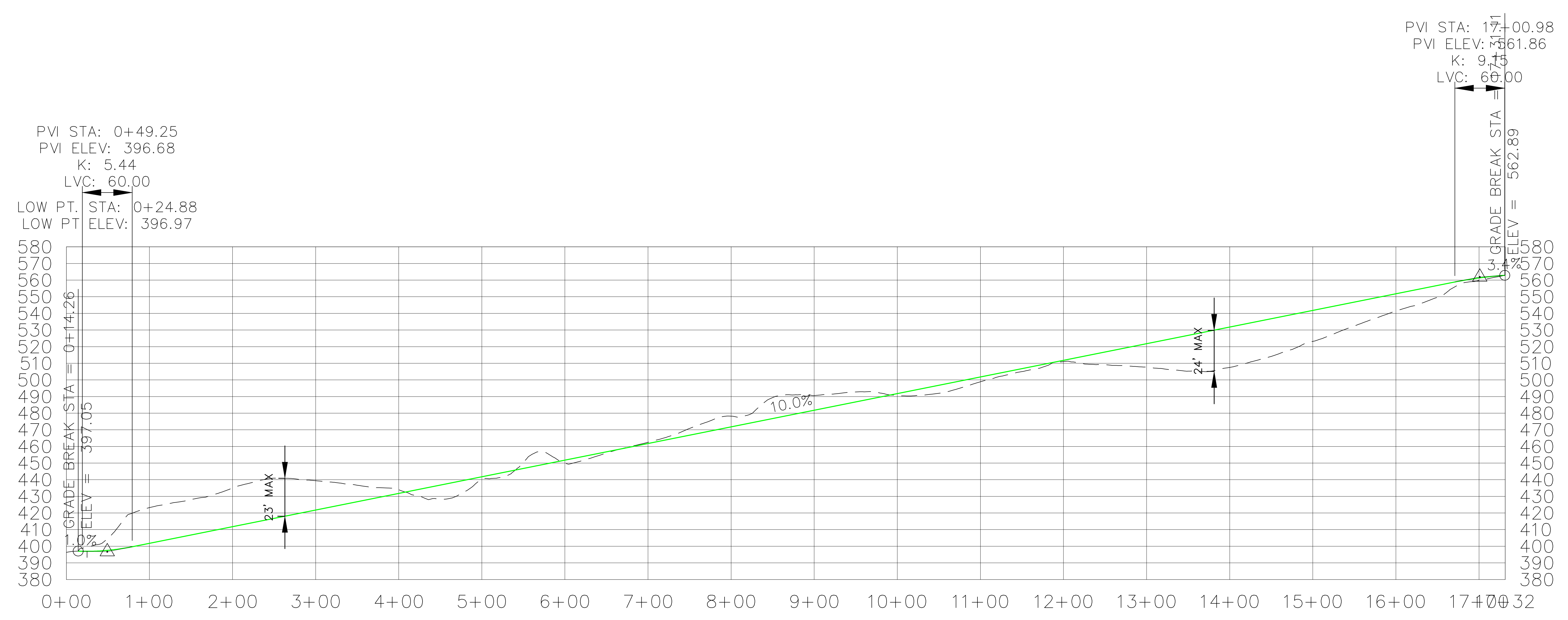

STUDIED ROUTE 4
 SCALE: V: 1" = 30'
 H: 1" = 60'

HORIZONTAL AND VERTICAL ALIGNMENTS WERE CHOSEN TO ASSURE THAT A MAXIMUM GRADE OF 10% WOULD NOT BE EXCEEDED WHILE MINIMIZING GRADING (CUTS AND FILLS), AND AVOIDING TURNS ALONG THE ROUTE THAT A DRIVER, UNFAMILIAR WITH THE DRIVE, MIGHT HAVE DIFFICULTY NEGOTIATING. CURVE RADII AND THE MAXIMUM GRADE OF 10% WERE CHOSEN TO BE IN ACCORDANCE WITH THE NYS FIRE CODE.

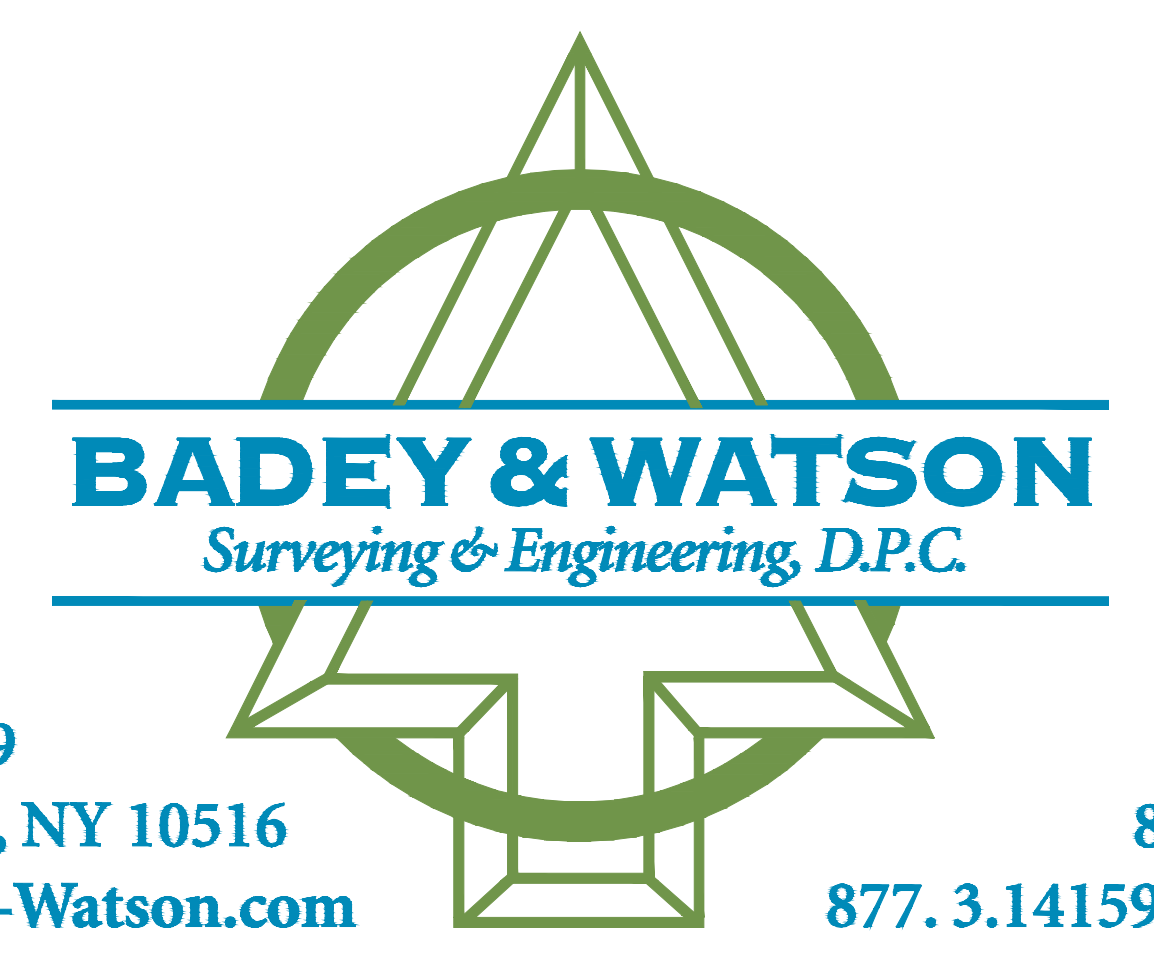

3063 Route 9
 Cold Spring, NY 10516
 www.Badey-Watson.com

845.265.9217
 877. 3.141593 (Toll Free)

SCALE 1" = 60'

RESPONSE TO COMMENTS THAT PHILIPSE BROOK ROAD EXIT SHOULD BE RELOCATED TO PROPOSED ENTRY ADJACENT TO CATSKILL AQUEDUCT