

DRAWING NAME: SB21792_R19_V17 LAYOUT: 11 SOUTH EROSION & SEDIMENT CONTROL W.D. NO.: 21792, 25231 CHECKED BY: MSM SPELL CHECKED BY: MJC DRAWN BY: MJC CLOSED BY: MJC T.M.: 17-1-77.2, 17-1-76.21, 17-1-76.11, 17-1-76.112, 17-1-76.112, 17-1-76.11, 17-1-48, 17-1-39

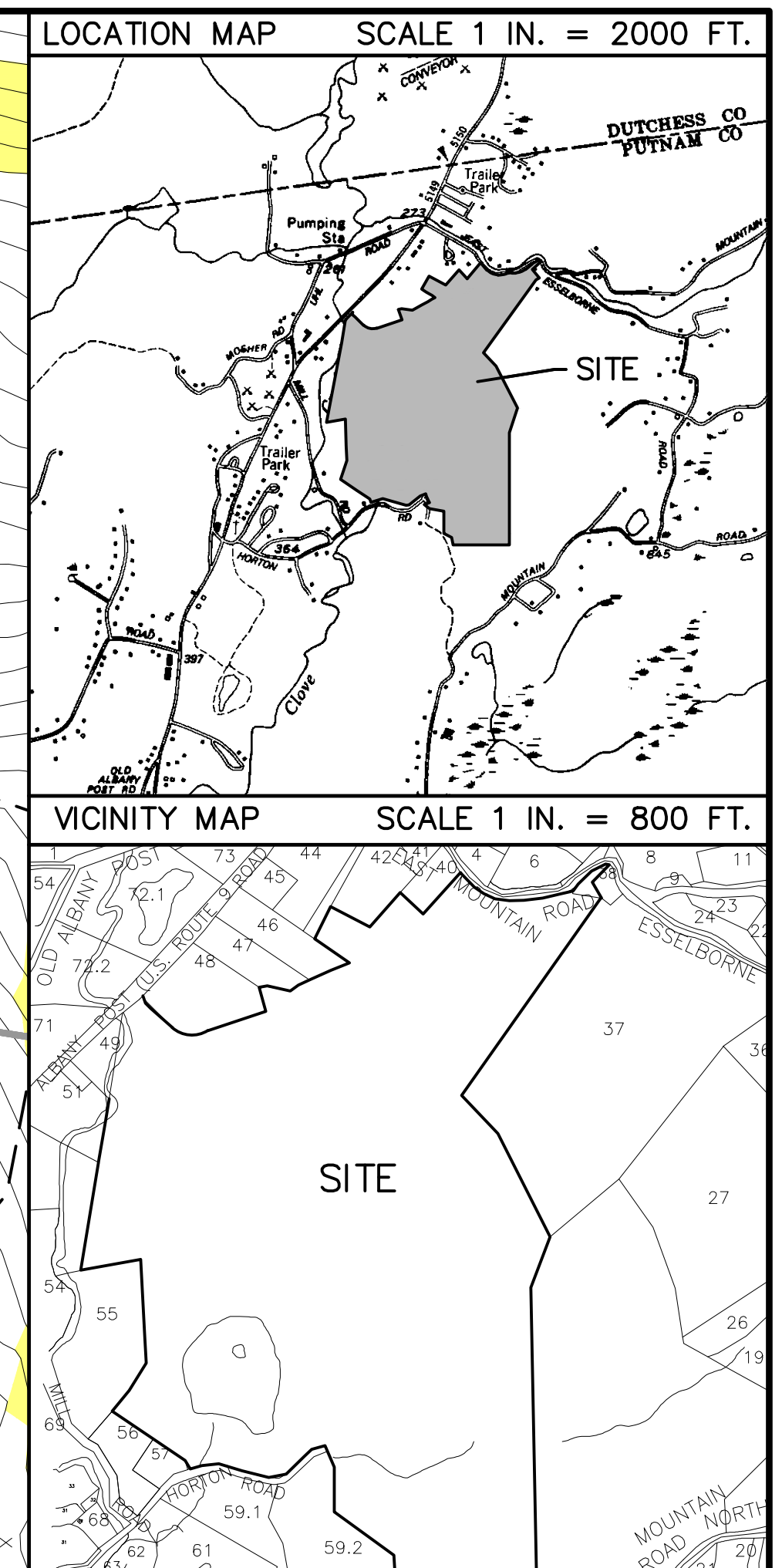
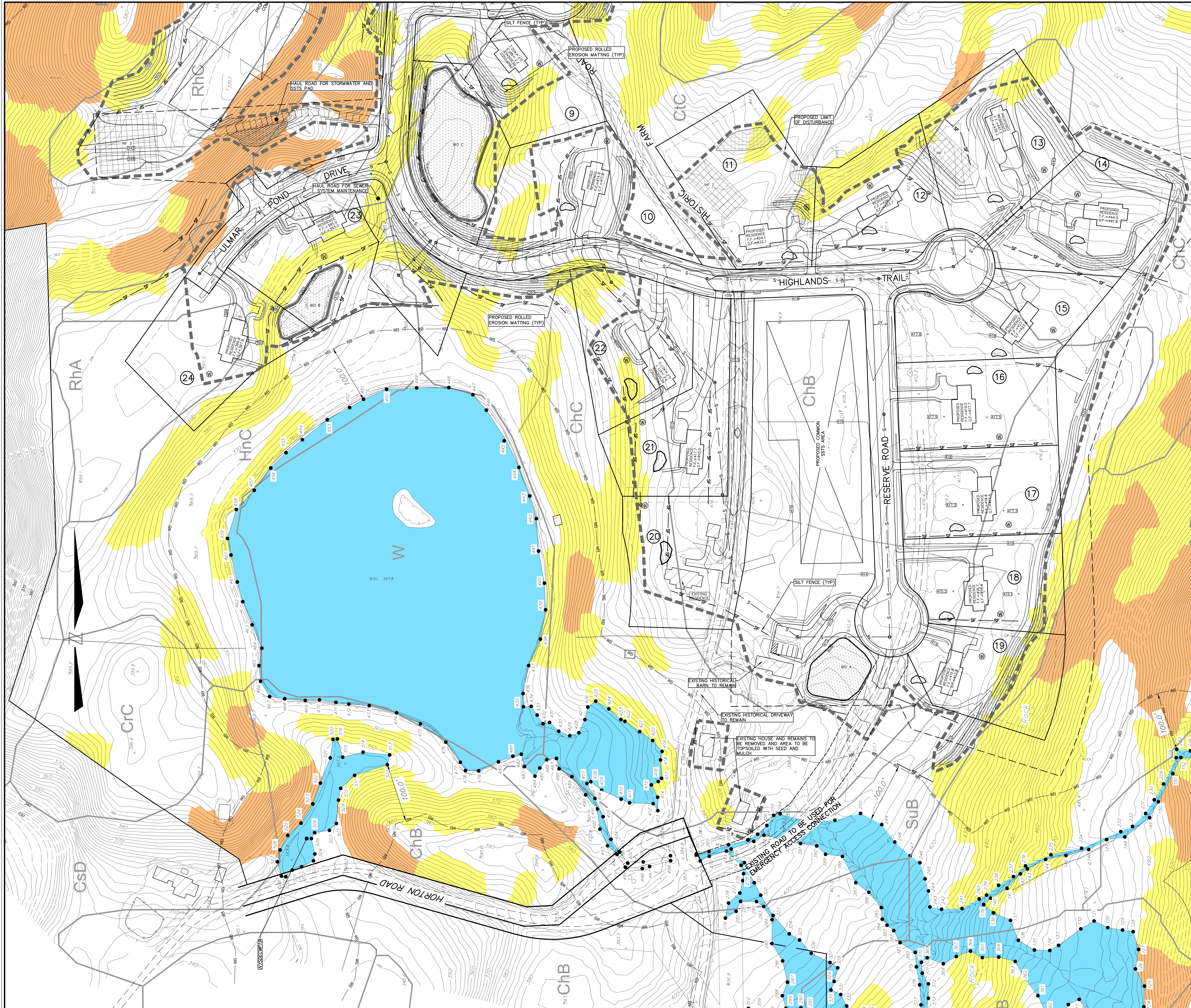

SITE DATA

TAX MAP NUMBER

SECTION:	17	17	17	17	17
BLOCK:	1	1	1	1	1
LOT:	39	48	76.111	76.112	76.21

REVISIONS

DATE	REVISION	DESCRIPTION
04/15/2021	R01	ORIGINAL DRAWING
11/04/2021	R16	FEIS RESPONSES
03/03/2022	R17	REVISED LOT LAYOUTS & SHORTENED RESERVE ROAD
	R19	FEIS RESPONSES

UNDERGROUND WARNING - NYS CODE RULE 753

NEW YORK STATE INDUSTRIAL CODE 53 REQUIRES EXCAVATORS TO CALL DIG SAFELY NEW YORK, INC. (800-962-7862) FOR A MEMBER-UTILITY LOCATION REQUEST AT LEAST TWO (2) WORKING DAYS, BUT NOT MORE THAN TEN (10) WORKING DAYS BEFORE ANY EXCAVATION OR DEMOLITION STARTS, REGARDLESS OF LOCATION. NOT ALL UTILITIES AND MUNICIPALITIES ARE MEMBERS OF DIG SAFELY NEW YORK, INC., AND NON-MEMBER UTILITY OPERATORS MUST BE CONTACTED DIRECTLY.

WARNING STAMP

ALTERATION OF THIS DOCUMENT, IN ANY WAY, BY ANY PERSON NOT UNDER THE DIRECTION OF A LICENSED PROFESSIONAL ENGINEER OR LAND SURVEYOR, AS APPROPRIATE, IS A VIOLATION OF THE EDUCATION LAW OF THE STATE OF NEW YORK.

PROJECT LOCATION

ROUTE 9, HORTON ROAD, E MT ROAD N
TOWN OF PHILIPSTOWN
COUNTY OF PUTNAM
STATE OF NEW YORK

PROPERTY OWNER

HORTON ROAD LLC
315 EAST 91ST STREET UNIT 2S
NEW YORK, NY 10128

APPLICANT

HORTON ROAD LLC
315 EAST 91ST STREET UNIT 2S
NEW YORK, NY 10128

PROJECT DESCRIPTION

24 LOT CONSERVATION SUBDIVISION.

PRELIMINARY PLAN SET
PREPARED FOR
HUDSON HIGHLANDS RESERVE
SOUTH EROSION & SEDIMENT CONTROL
SCALE: 1" = 50'

PRELIMINARY **PRINTED**

February 28, 2022

BADEY & WATSON
Surveying & Engineering, D.P.C.

LICENSE No. 103021

3063 Route 9
Cold Spring, NY 10516
www.Badey-Watson.com

845.265.9317
877.3.141593 (Toll Free)

SHEET 11 OF 19