

DRAWING NAME: SB21792_R19_V17 LAYOUT: 14. SANITARY PROFILE LAYOUT W.O. NO.: 21792, 25231 CHECKED BY: MSM SPELL CHECKED BY: MAC DRAWN BY: MAC CLOSED BY: ONK T.M.: 17-1-77.2, 17-1-76.21, 17-1-76.11, 17-1-76.112, 17-1-76.11, 17-1-48, 17-1-39 GEOGRAPHIC INDEX: 540753 617716

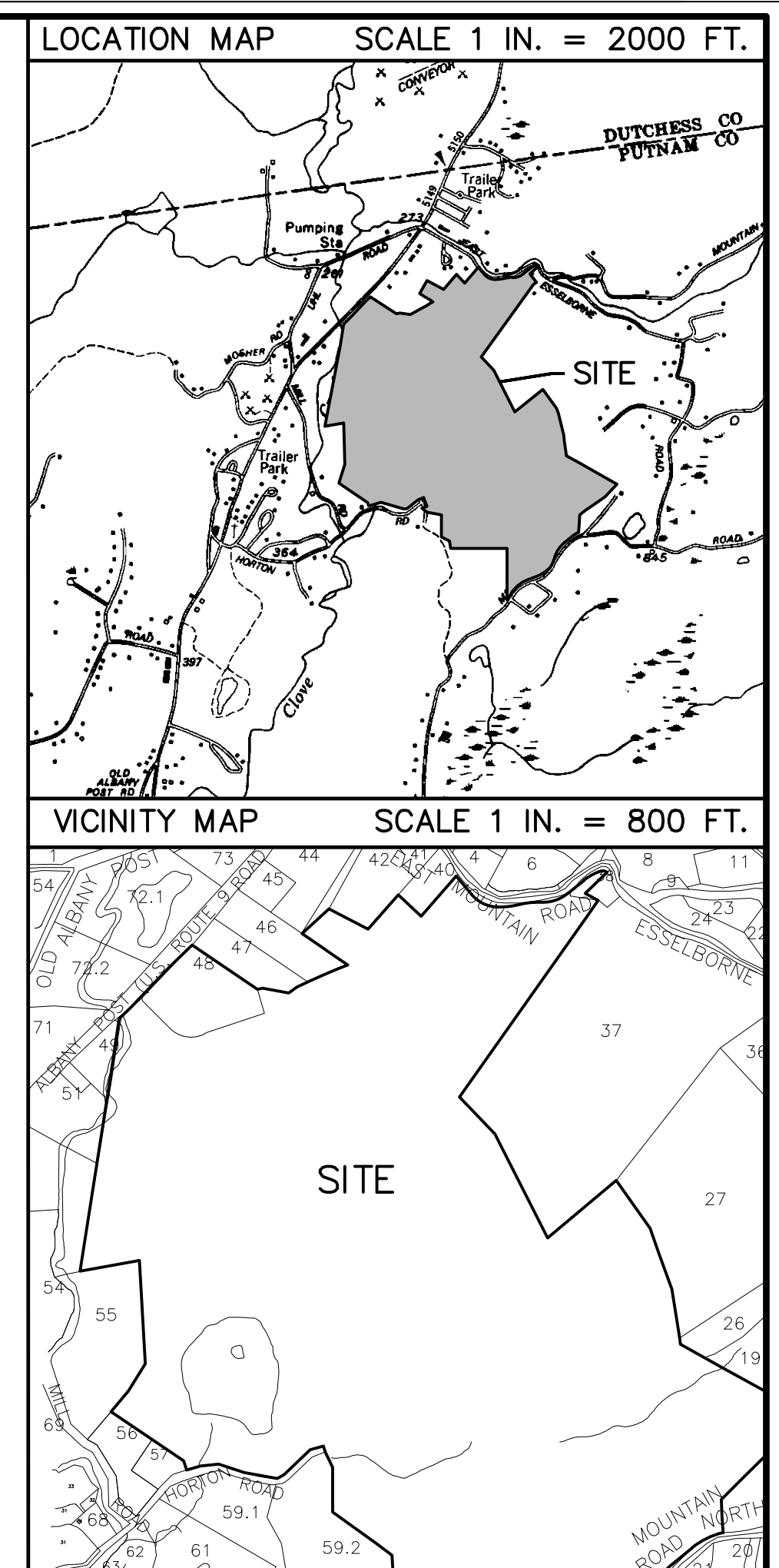
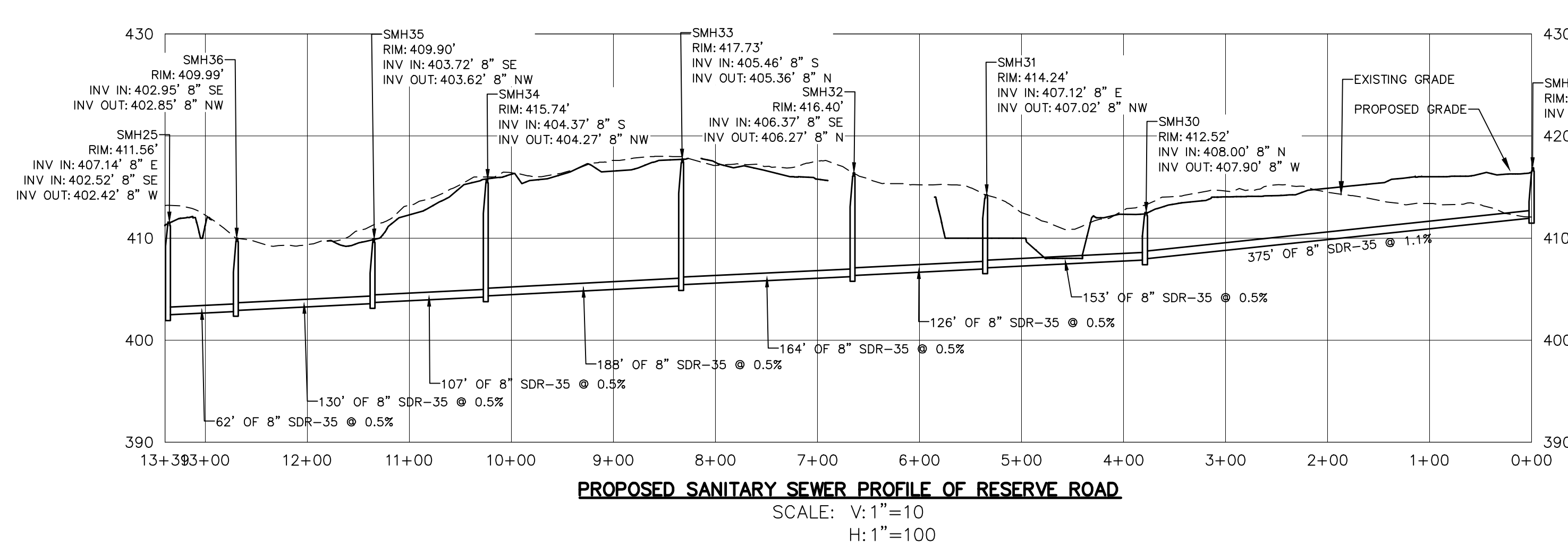
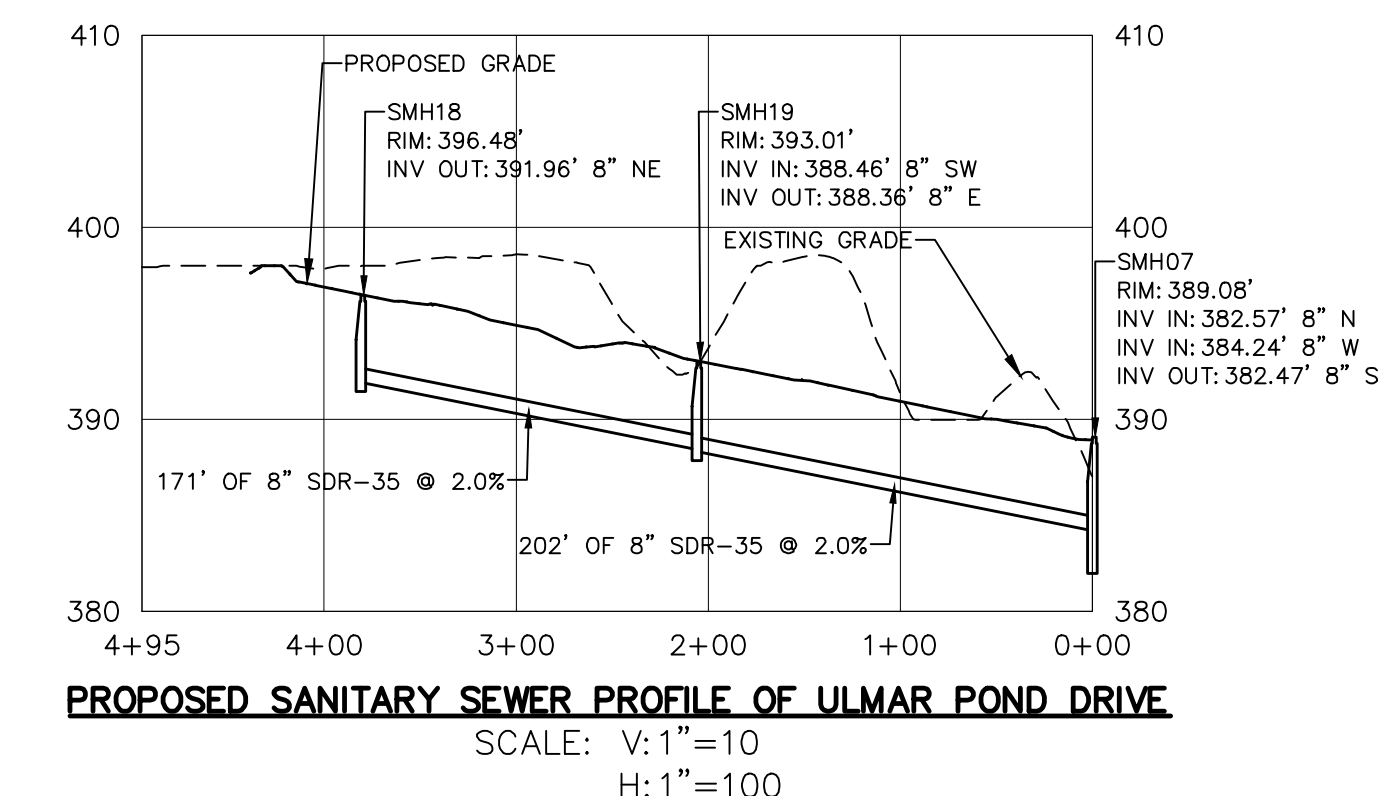
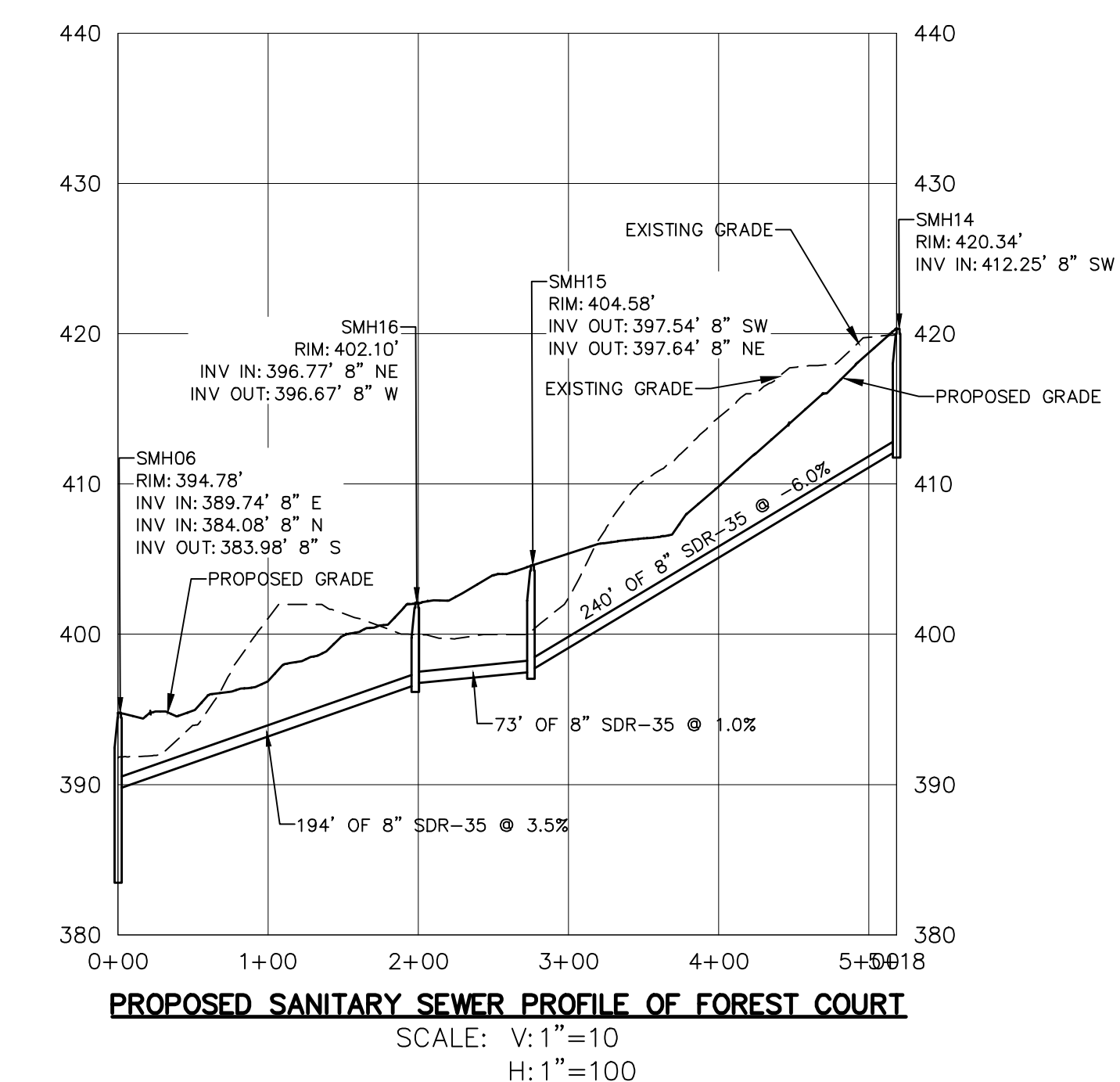
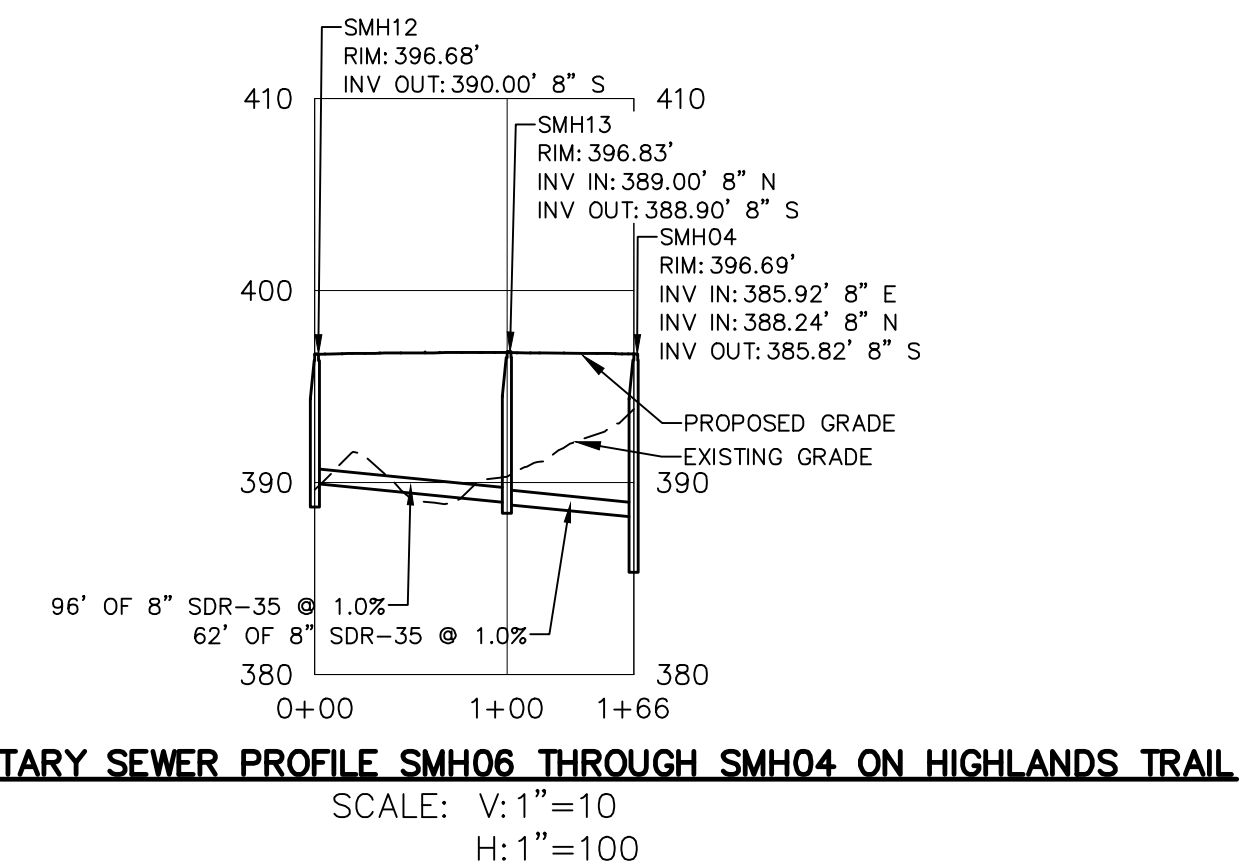
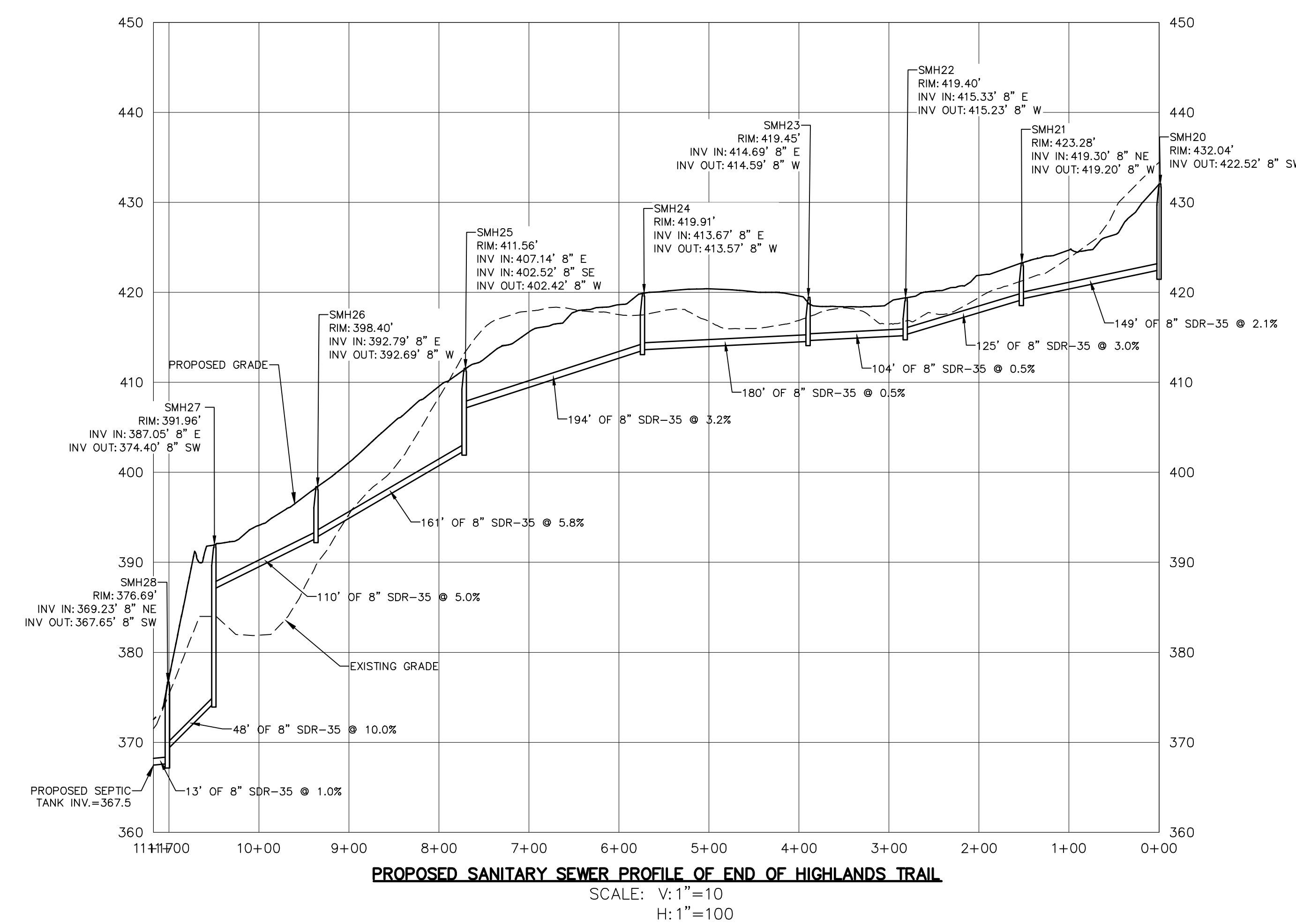
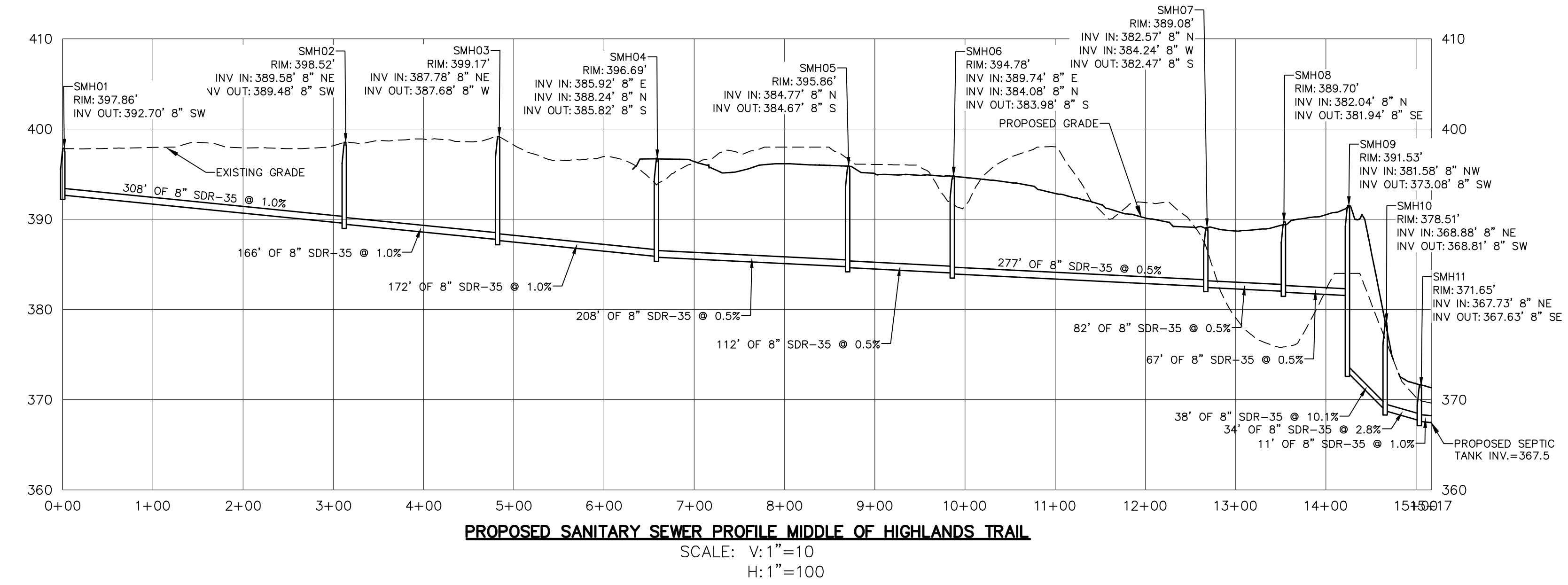

SITE DATA

TAX MAP NUMBER					
SECTION:	17	17	17	17	17
BLOCK:	1	1	1	1	1
LOT:	39	48	76.111	76.112	77.2
REVISIONS					
DATE	REVISION	RO1	DESCRIPTION		
04/15/2021	R16		ORIGINAL DRAWING		
03/03/2022	R19		FEIS RESPONSES		

UNDERGROUND WARNING - NY CODE RULE 753
NEW YORK STATE INDUSTRIAL CODE 53 REQUIRES EXCAVATORS TO CALL DIG SAFELY NEW YORK, INC. (800-962-7862) FOR A MEMBER-UTILITY LOCATION REQUEST AT LEAST TWO (2) WORKING DAYS, BUT NOT MORE THAN TEN (10) WORKING DAYS BEFORE ANY EXCAVATION OR DEMOLITION STARTS, REGARDLESS OF LOCATION. NOT ALL UTILITIES AND MUNICIPALITIES ARE MEMBERS OF DIG SAFELY NEW YORK, INC., AND NON-MEMBER UTILITY OPERATORS MUST BE CONTACTED DIRECTLY.

WARNING STAMP

ALTERATION OF THIS DOCUMENT, IN ANY WAY, BY ANY PERSON NOT UNDER THE DIRECTION OF A LICENSED PROFESSIONAL ENGINEER OR LAND SURVEYOR, AS APPROPRIATE, IS A VIOLATION OF THE EDUCATION LAW OF THE STATE OF NEW YORK.

PROJECT LOCATION

ROUTE 9, HORTON ROAD, E MT ROAD N
TOWN OF PHILIPSTOWN
COUNTY OF PUTNAM
STATE OF NEW YORK

PROPERTY OWNER

HORTON ROAD LLC
315 EAST 91ST STREET UNIT 2S
NEW YORK, NY 10128

APPLICANT

HORTON ROAD LLC
315 EAST 91ST STREET UNIT 2S
NEW YORK, NY 10128

PROJECT DESCRIPTION

24 LOT CONSERVATION SUBDIVISION.

PRELIMINARY PLAN SET
PREPARED FOR
HUDSON HIGHLANDS RESERVE
SANITARY PROFILE LAYOUT

SCALE : AS NOTED

PRINTED
February 28, 2022
BADEY & WATSON
Surveying & Engineering, D.P.C.
LICENSE No. 103021

3063 Route 9
Cold Spring, NY 10516
www.Badey-Watson.com

845.265.9217
877.3.141593 (Toll Free)

BADEY & WATSON
Surveying & Engineering, D.P.C.

SHEET 14 OF 19