

SEE DETAIL SHEET S5 FOR
RETAINING WALL FOOTING
AND WALL DETAILS

HIGH WALL FOUNDATION CONSTRUCTION:
10" THICK POURED CONCRETE FOUNDATION (3000 PSI)
WALL TO CONTAIN (1) #5 RE-BAR VERTICALLY, 12" O.C.
AND (1) #4 RE-BAR HORIZONTALLY 12" O.C. TIE TOGETHER
3" FROM OUTFACE OF WALL. VERTICAL BARS ARE TO BE HOOKED
16" INTO FOOTING AND EXTEND UP WALL AS SHOWN
HOLD BARS 3" FROM OUTFACE OF WALL
ABOVE GRADE TO HAVE CEMENTIOUS PARGE, BELOW GRADE
TO HAVE (2) COATS OF BITUMINOUS WATERPROOFING
SEE DETAIL SHEET S5

HIGH WALL FOUNDATION CONSTRUCTION:
10" THICK POURED CONCRETE FOUNDATION (3000 PSI)
WALL TO CONTAIN (1) #5 RE-BAR VERTICALLY, 12" O.C.
AND (1) #4 RE-BAR HORIZONTALLY 12" O.C. TIE TOGETHER
3" FROM OUTFACE OF WALL. VERTICAL BARS ARE TO BE HOOKED
16" INTO FOOTING AND EXTEND UP WALL AS SHOWN
HOLD BARS 3" FROM OUTFACE OF WALL
ABOVE GRADE TO HAVE CEMENTIOUS PARGE, BELOW GRADE
TO HAVE (2) COATS OF BITUMINOUS WATERPROOFING
SEE DETAIL SHEET S5

12" DIA. CONC. PIERS, (3000 PSI)
WITH BIGFOOT BF24 BASES
PIER TO CONTAIN (2) #4 REBAR
VERTICALLY
PIER BASE TO REST ON UN-DISTURBED
SOIL WITH MIN. BEARING CAPACITY
OF 3000 PSF
PIER BASE TO BE 42" BELOW FINISHED
GRADE MIN.
PROVIDE 1/2" X 4" SIMPSON TITEN HD
SECURING SIMPSON AB466 POST BASE
(10 PLACES)

LOW WALL FOOTING CONSTRUCTION:
24" WIDE X 12" THICK CONC. FOOTING. FOOTING TO CONTAIN
(3) #4 RE-BAR LONGITUDINALLY, 9" O.C., 3" OFF BOTTOM, AND (1)
#5 RE-BAR 24" O.C. HOOKED 6" INTO FOOTING AND EXTENDING 36" UP
WALL, TIED TO WALL BARS. PROVIDE 2" X 4" KEY
FOOTING TO REST ON UN-DISTURBED SOIL WITH MIN. BEARING
CAPACITY OF 3000 PSF. FOOTING TO BE STEPPED TO REMAIN
42" BELOW FINISHED GRADE MIN.

LOW WALL FOOTING CONSTRUCTION:
24" WIDE X 12" THICK CONC. FOOTING. FOOTING TO CONTAIN
(3) #4 RE-BAR LONGITUDINALLY, 9" O.C., 3" OFF BOTTOM, AND (1)
#5 RE-BAR 24" O.C. HOOKED 6" INTO FOOTING AND EXTENDING 36" UP
WALL, TIED TO WALL BARS. PROVIDE 2" X 4" KEY
FOOTING TO REST ON UN-DISTURBED SOIL WITH MIN. BEARING
CAPACITY OF 3000 PSF. FOOTING TO BE STEPPED TO REMAIN
42" BELOW FINISHED GRADE MIN.

LOW WALL FOUNDATION CONSTRUCTION:
10" THICK POURED CONCRETE FOUNDATION (3000 PSI)
WALL TO CONTAIN (1) #5 RE-BAR VERTICALLY, 24" O.C.
AND (1) #5 RE-BAR HORIZONTALLY 24" O.C. TIE TOGETHER
AT MID-WALL
ABOVE GRADE TO HAVE CEMENTIOUS PARGE, BELOW GRADE
TO HAVE (2) COATS OF BITUMINOUS WATERPROOFING

LOW WALL FOUNDATION CONSTRUCTION:
10" THICK POURED CONCRETE FOUNDATION (3000 PSI)
WALL TO CONTAIN (1) #5 RE-BAR VERTICALLY, 24" O.C.
AND (1) #5 RE-BAR HORIZONTALLY 24" O.C. TIE TOGETHER
AT MID-WALL
ABOVE GRADE TO HAVE CEMENTIOUS PARGE, BELOW GRADE
TO HAVE (2) COATS OF BITUMINOUS WATERPROOFING

4" CONC. SLAB (3000 PSI)
SLAB TO REST ON A 6 MIL. V.B.
WITH TAPED EDGES
ON A 6" LAYER OF 3/4" CLEAN STONE
ON UN-DISTURBED SOIL WITH MIN
BEARING CAP OF 3000 PSF.
PROVIDE 6X8 8/8 WYM AT MID-SLAB
PROVIDE 2" RIGID DOW EPS AT OWNER'S
DIRECTION (OPTIONAL)

MASONRY OPENING WIDTH SIZED TO
ALLOW A 2X6 PT BUCK TO EXTEND TO
TOP OF SLAB FOR DOOR MOUNTING
IF BUCK IS NOT BEING USED, REDUCE
MASONRY OPENING WIDTH BY 3" (3'-2.5')

DROP WALL 8" BELOW TOP OF SLAB
AT DOORS, BEND WALL BARS 16" INTO
CENTER OF SLAB AND POUR SLAB
OVER WALL, PROVIDE 1/2" WASH FROM
OUTFACE OF DOOR TO SLAB EDGE
(7 DOORS)

PROPOSED FOUNDATION PLAN
SCALE: 1/4"=1'-0"

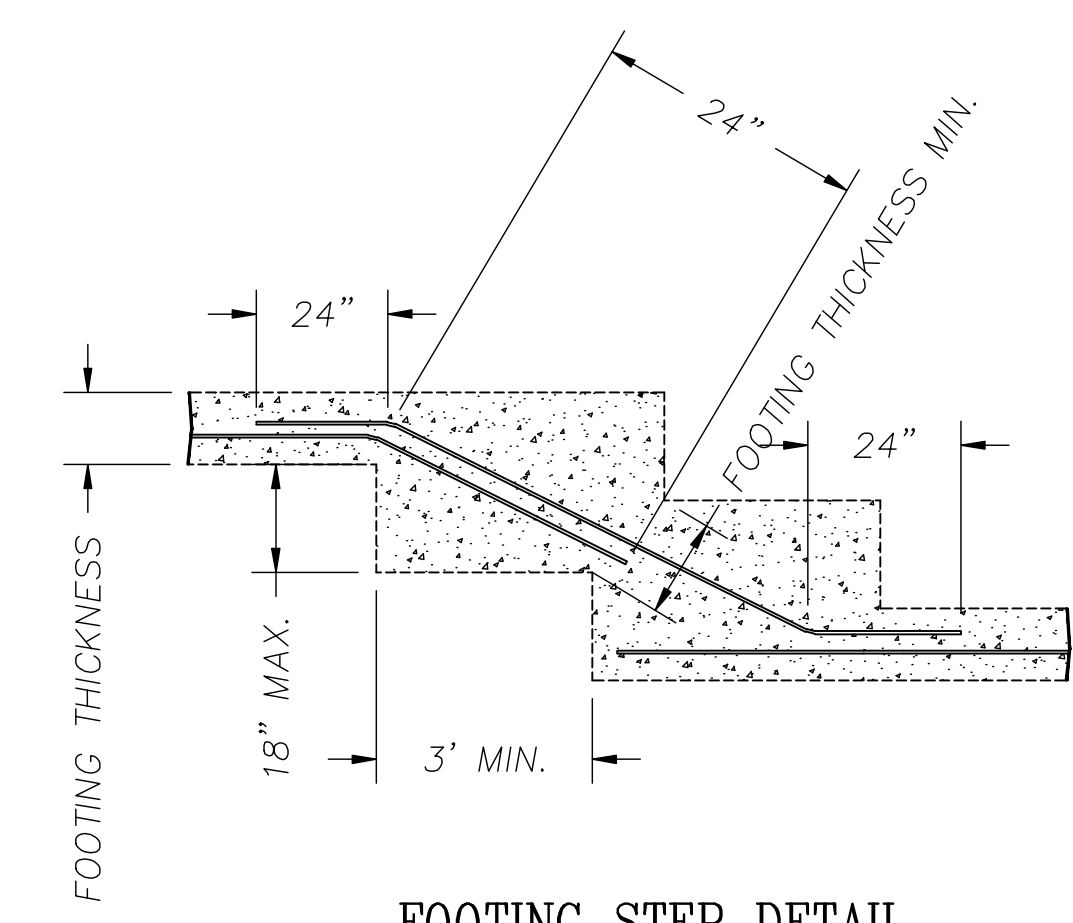

FOOTING STEP DETAIL
SCALE: NONE
NOTE: BOTTOM OF FOOTING TO REST ON
UN-DISTURBED SOIL WITH MIN. BEARING CAPACITY OF
3000 PSF. BOTTOM OF FOOTING TO BE 42" B.F.G. MIN.

1	12/21/21	Initial Release
No:	Date:	Description:
New Garage		
MICHAEL P. CARR P.E. Consulting Engineer 13 Woodland Drive Garrison, NY 10524 Phone: (914) 426-6119 email: mcarr@cmr-eng.com		
CLIENT: Cedar Hill Acres LLC 18 East Mountain Road North Cold Spring, NY 10516		
LOCATION: Town of Philipstown Putnam County		
DATE: Dec 14, 2021	TITLE: Foundation Plan	SHEET NO: S2
SCALE: AS NOTED		
DRAWN BY: MPC		